

INSTRUCTIONS:

1. Connect top panel to vertical panel with glue and dowels.
2. Attach knockdown fastener mount plate to underside of vertical panel by screwing into pre-drilled holes.
3. Screw knockdown fastener studs to the bottom panel using pre-drilled holes.
4. Align knockdown fastener stud with knockdown fastener mount plate and snap into place.

Jofco

P.O. Box 71 | Jasper, Indiana 47546 | 800-23-JOFCO | www.jofco.com

Instruction Sheet Number: IFLFoo1
Credenza Top with Niche Assembly

Effective Date: 1-1-11 CG14

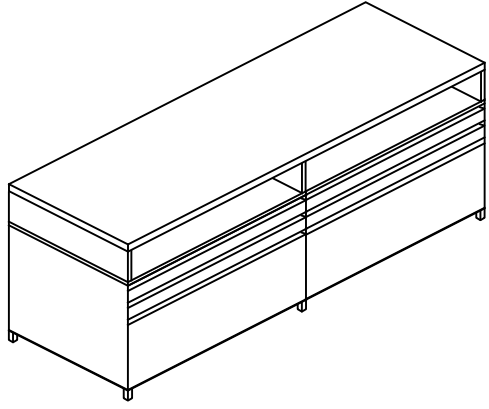
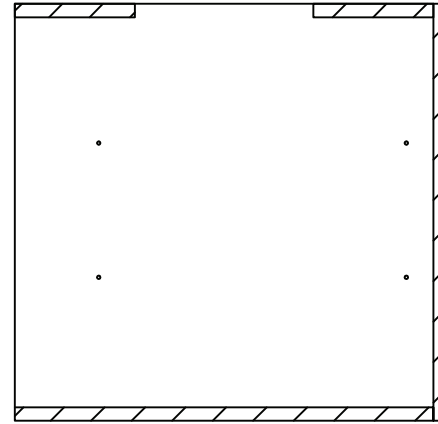
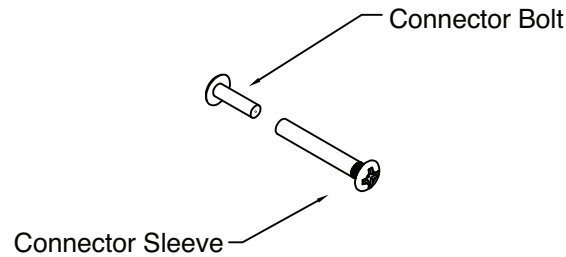
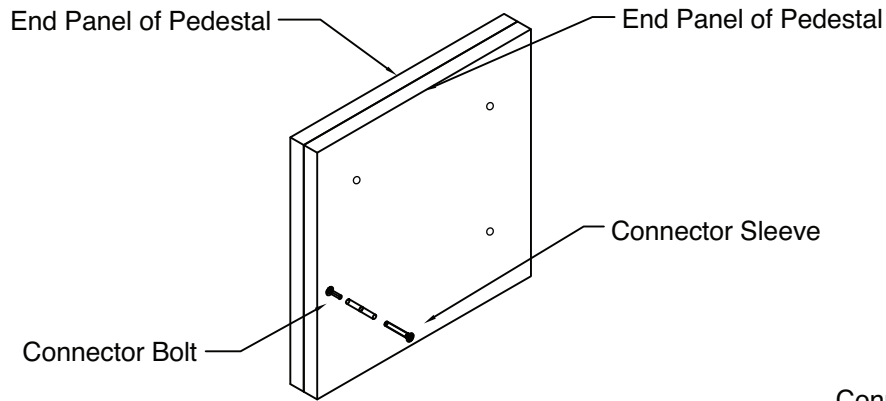

Illustration may vary from product



Side View



INSTRUCTIONS:

1. Remove drawers from each pedestal that needs connected.
2. Align pedestals and connector bold holes.
3. Insert connector sleeves into each of the four (4) holes provided.
4. Screw connector bolts into connector sleeve from opposite pedestal.
5. Insert drawers.

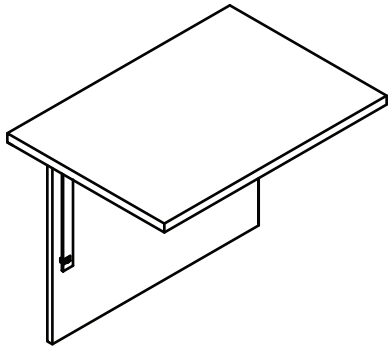

Modesty Panel

Illustration may vary from product shown attached to work surface top

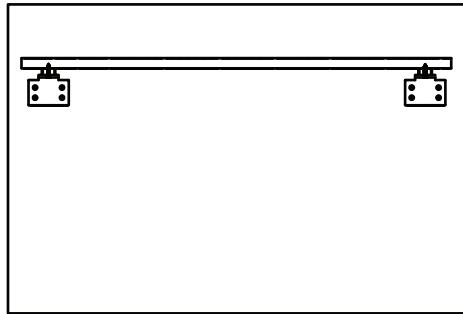

Underside View
(of work surface top)

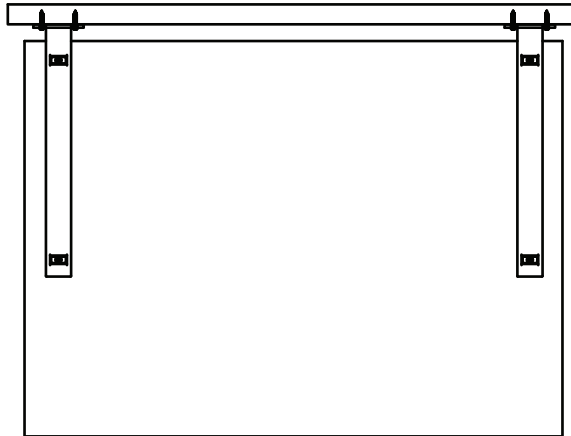

Front View
(from user side)

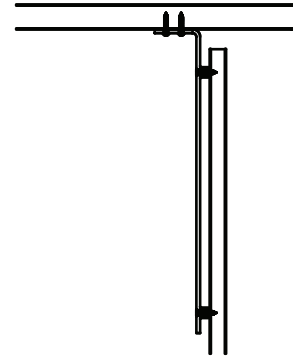

Profile View

INSTRUCTIONS:

1. Attach top mounted brackets to modesty panel with screws provided. Brackets should be placed approximately 2-1/2" from each side.
2. Align modesty panel below work surface - 4" inset from credenza top or 6" inset from desk top and 1" below work surface. Secure with screws provided.

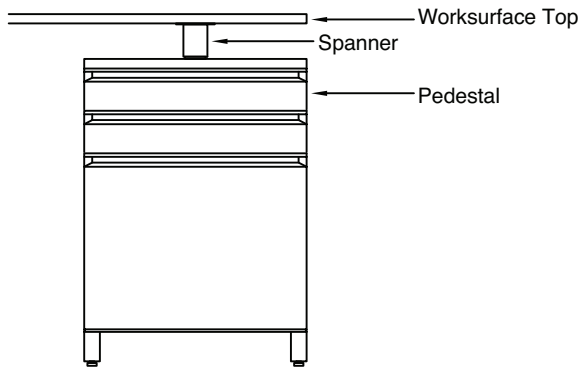

Desk with Pedestal Support
Illustration may vary from product

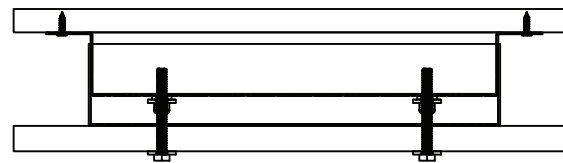
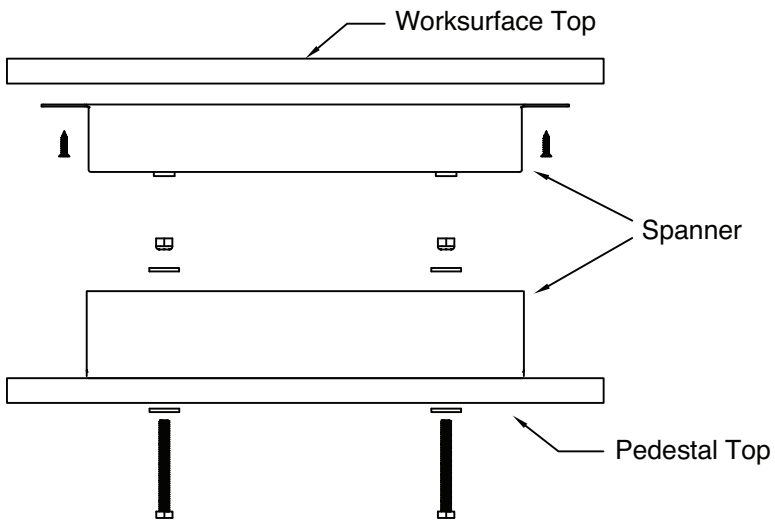
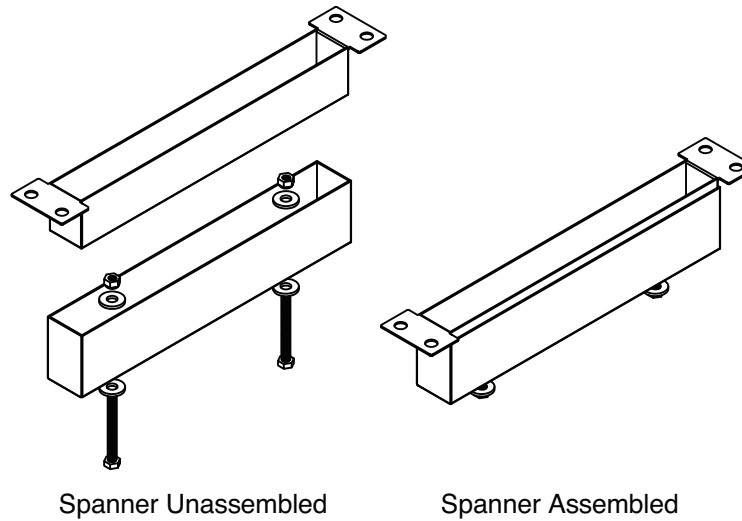

INSTRUCTIONS:

1. Remove top drawer box of pedestal.
2. The spanner comes in two parts (see illustration). Align the bottom half with the holes on top of pedestal.
3. Insert bolts through the holes from inside the pedestal.
4. Snuggly screw lock nuts down on bolts from spanner side (top of pedestal).
5. Attach top half of spanner to bottom of worksurface using provided screws and pre-bored holes.
6. Align top and bottom of spanner.
7. Adjust height of spanner by turning bolt from inside pedestal.

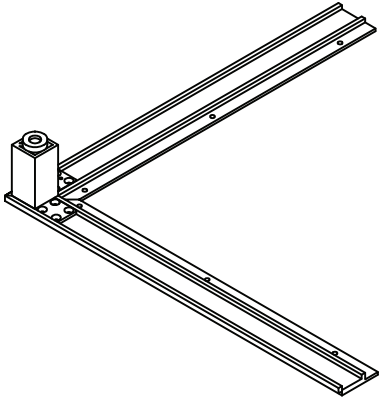

Assembled View (underside)
Illustration may vary from product

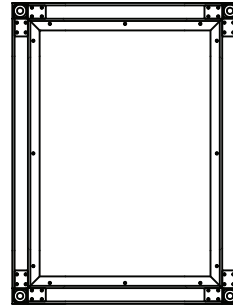
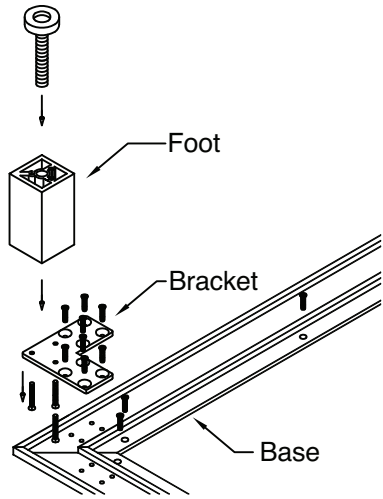

Single Pedestal

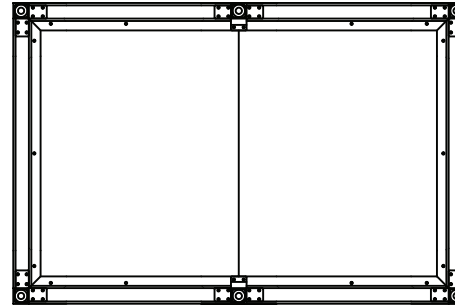

Multiple Pedestal

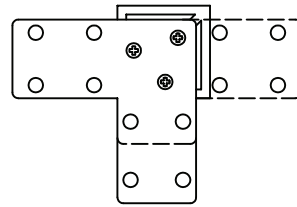

Figure A
Foot to Bracket Assembly
Three (3) Screws

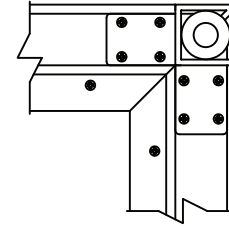

Figure B
L-Bracket to Base Assembly
Eight (8) Screws

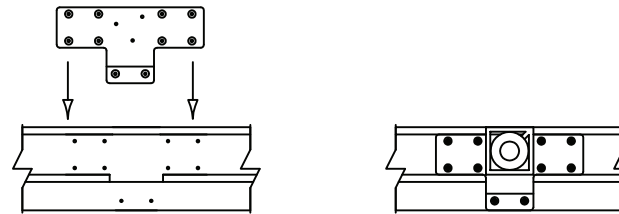
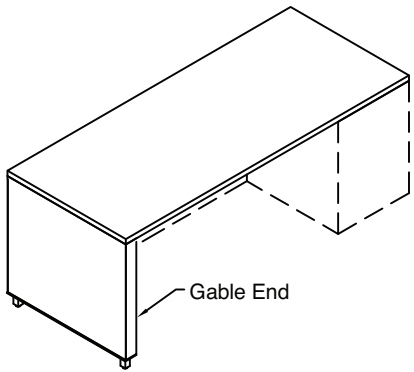

Figure C
Notched Bracket Assembly (multiple pedestal only)
Ten (10) Screws

INSTRUCTIONS:

1. Attach a foot to each L-bracket using three (3) screws.
2. Attach L-bracket to corner of base with foot using eight (8) screws. Repeat for each corner.
4. For multiple pedestal applications, attach a foot to each of the notched brackets using three (3) screws. Attach to notch of base.
5. Align assembled base to bottom side of unit and secure with screws.



Desk with Gable End Support
Illustration may vary from product
right unit shown

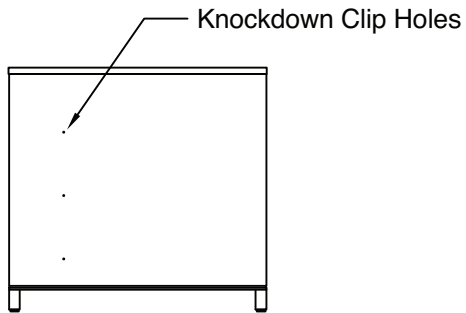
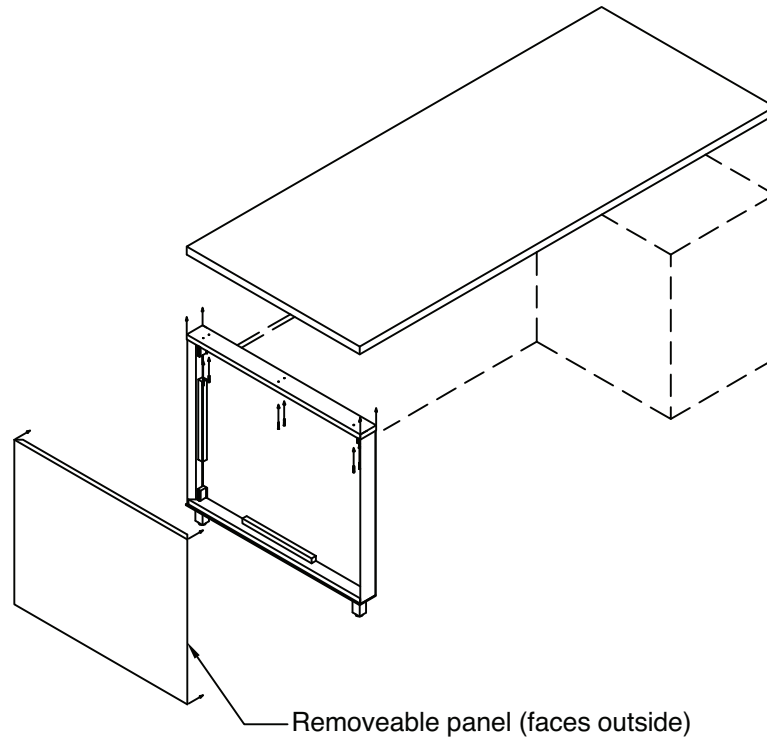

Side View

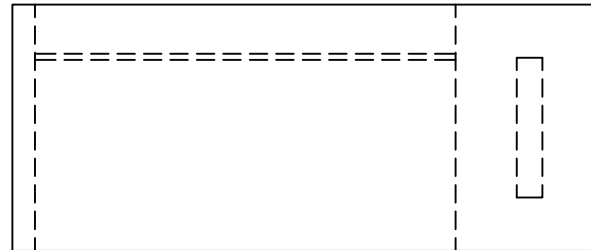

Top View

INSTRUCTIONS:

1. Remove outside panel of gable end which is held into place with magnet catches.
2. Install gable end to modesty panel using knockdown clips provided.
3. Align top with gable end and attach with provided screws.
4. Reattach outside panel of gable end.

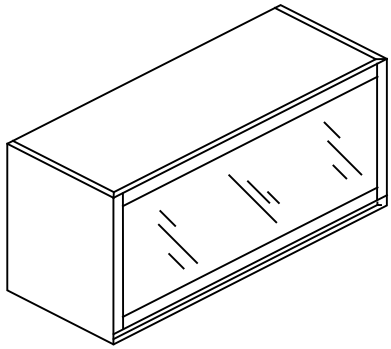

Wall Mounted Binder Bin
Illustration may vary from product

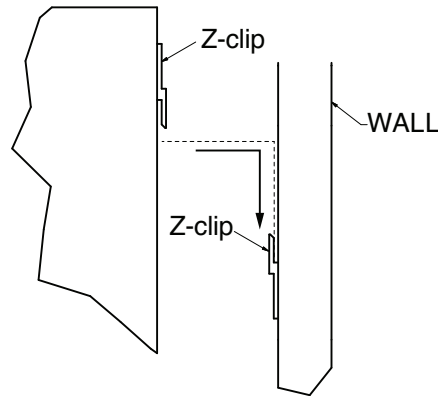
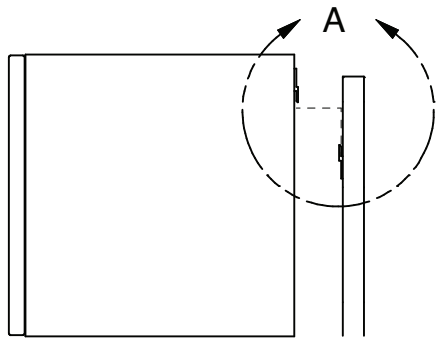
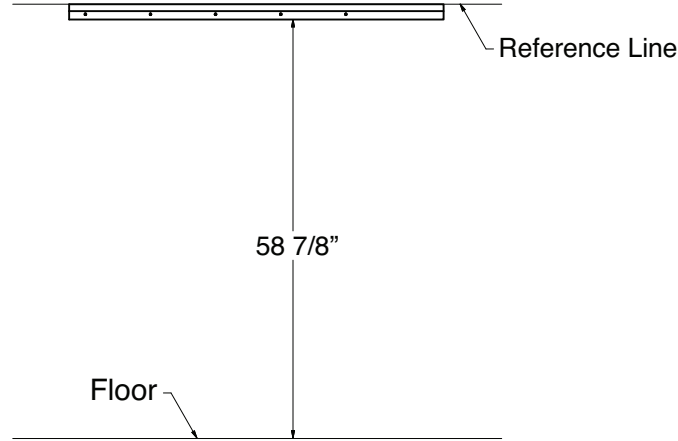

DETAIL A

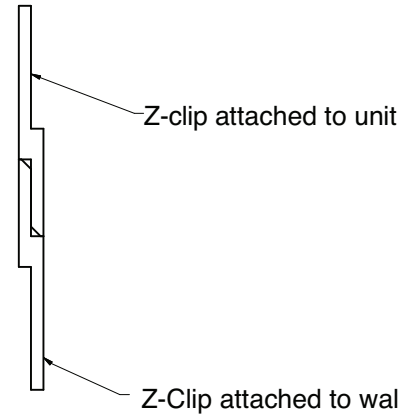

INSTRUCTIONS:

1. On the wall the furniture will be attached, find the highest point on the floor. At that point measure up 58 7/8".
2. Using a level, establish the reference line for the binder bin(s).
3. Align the top of the wall mount bracket (z-clip) to the reference line and attach to wall.
4. The binder bin has a factory installed z-clip that mates to the z-clip attached to the wall. Place unit(s) in approximate location. The opposing z-clips should mate.

Adjustments for alignment can be made by lifting slightly to disengage the nexted z-clip.

Hardware is provided by installer. Consulting with a contractor for proper mounting is recommended.

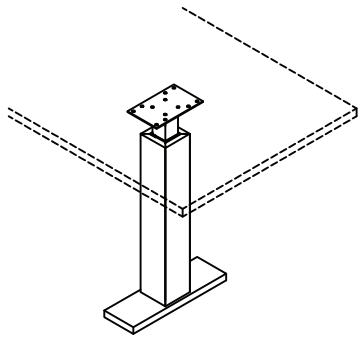

Desk with Leg Post
 Illustration may vary from product

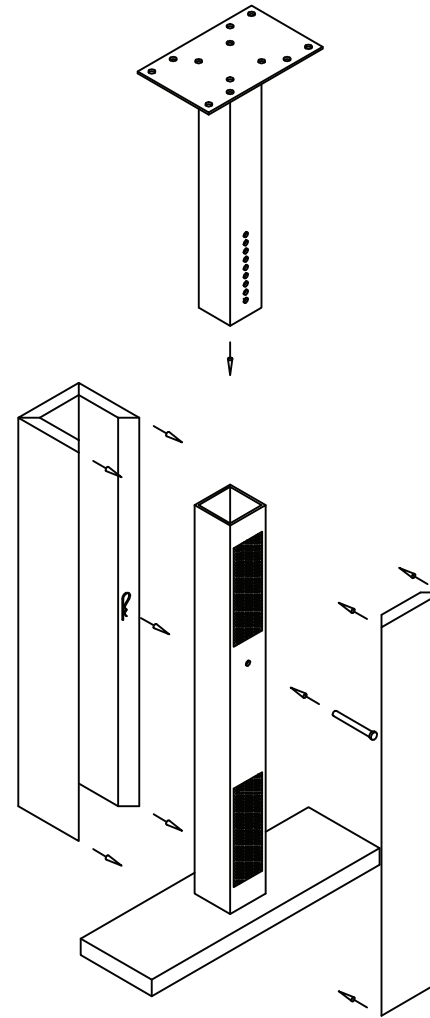
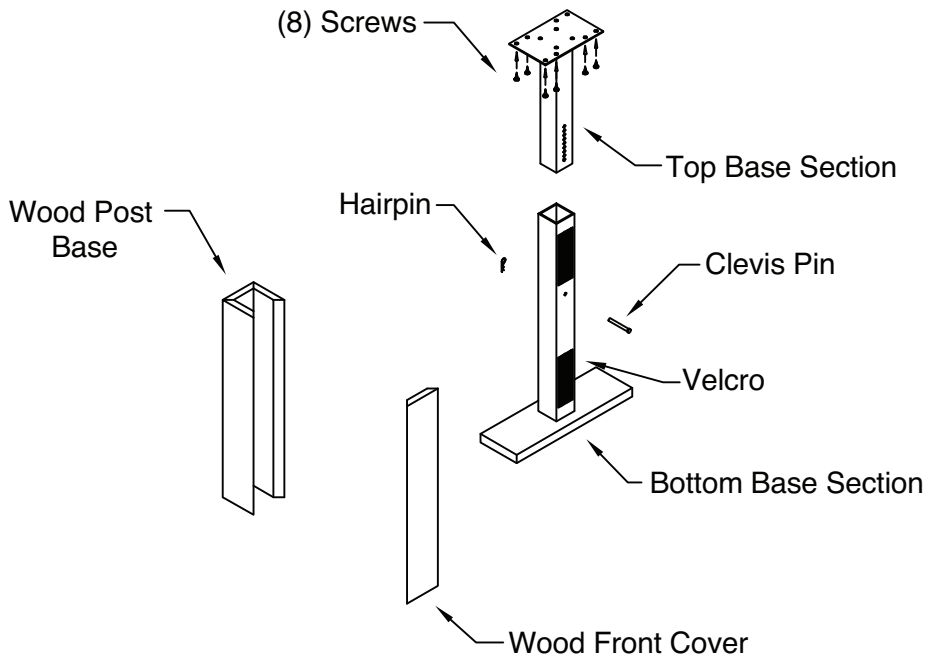

INSTRUCTIONS:

1. Insert top base section into bottom base section.
2. Secure top and bottom sections by inserting the clevis pin through the whole provided and interlocking with the hairpin.
3. Attach the metal base to the underside of the worksurface using eight (8) screws and the pre-drilled holes.
4. Slide wood post base around metal base and align. Secure both parts of the wood base with velcro provided.

Jofco

P.O. Box 71 | Jasper, Indiana 47546 | 800-23-JOFCO | www.jofco.com

Instruction Sheet Number: IFLF010

Post Base Assembly

Effective Date: 1-1-11 CG23