

Conferencing Price List

General Information &

Terms of Sale2-4

Collective®Conference & Meeting

Conference Tables5-52
Meeting Tables53
Conference Table Tops54-57
Conference Table Bases57-62
Accessories62-64

Conferencing Collection

CaseWorks by Jofco®66-68
Reflections69-71
Wall Street72-74
Wellington75-80
Walden81-83
Complementary Components84
Conferencing Table Tops85-91
Conferencing Table Bases ..92-100

inForm™

Overview102-103
Training Tables104
Connecting Tops104-106
Ganging Hardware106
Tri-Power Units106

Power & Data110-115

Index116-117

Jofco memberships include:



Sustainability

Jofco is a Forest Stewardship Council (FSC) certified manufacturing facility. Some products are BIFMA level™ certified by SCS. Jofco products are made in the United States.



General Information

Pricing and Terms

Prices found in this book are list prices in U.S. dollars for standard product and do not include storage, installation or taxes. Prices are effective the date printed on the front cover or on a Jofco-issued sticker and supersede all other printed price lists. Shipments are F.O.B Jasper, Indiana, are prepaid, and allowed to dealers dock in the 48 contiguous states. Export pricing is available through the sales department.

All illustrations, specifications and prices are based on information available at the time of printing and are subject to change without notice. Measurements are rounded to the nearest 1/8". Product changes, including but not limited to design, color, material, construction and discontinuance, are at the discretion of Jofco at any time without prior notice.

Orders can only be received from dealers authorized by Jofco. Acceptance of orders are subject to credit approval, and barring any acts of government or causes beyond our control (strikes, fire, embargo of materials, etc.), shipments are invoiced at the published price at time of order. Standard terms are 1% - 15 days, net 30 days. Finance charges are added on delinquent accounts over 30 days.

Quotes and Acknowledgements

Quotes from Jofco must be accepted within 60 days or they will need to be re-submitted. Accepted orders are confirmed via Acknowledgement. The Acknowledgement lists detailed information pertaining to the order as well as an anticipated shipping date. It is the purchaser's responsibility to immediately verify the information is correct and notify Jofco in writing of any changes. Order changes may result in adjustment of ship date.

Changes and Cancellations

Acknowledged orders are not subject to change or cancellation. In the event Jofco is able to stop an order prior to production, a fee will apply. Restocking fees applicable to non-stocked textile or leathers may also apply. Special finishes or special construction items cannot be cancelled once production has begun.

Storage

If purchaser cannot accept delivery upon order completion, a storage fee will apply and purchaser will be invoiced for the order. Larger orders may require purchaser to arrange for a climate controlled outside storage facility. Extreme temperatures and/or humidity will void Jofco warranty. Purchaser bears all risks associated with third-party storage and is responsible for transporting furniture to final destination.

Delivery

Jofco products are shipped via Jofco trucks or contract carrier when possible. Shipments are consigned to, and are the property of, the dealer once it leaves our dock. Jofco reserves the right to select the most appropriate routing and will honor specific requests when possible.

Delivered orders are subject to a minimum charge of \$150 net for shipping/handling on orders less than 300 lbs. Contract carriers quote directly and separately for inside delivery.

Damages and Claims

Jofco products are packed in cartons and meet or exceed existing furniture and seating codes. If you detect damaged product or shortages, do not refuse the order. Note discrepancies on the bill of lading and immediately file a claim with the carrier. Products are delivered to the shipper in good condition and Jofco's liability ceases at that time. Storage in areas of uncontrolled humidity and temperature may cause damage and void Jofco warranties.

Concealed damages must be reported to the carrier for their inspection within 15 days of delivery. Do not destroy cartons or move the product until the carrier has inspected for damages as it may void your claim.

Returns and Repairs

Prior to any return or repair, factory authorization and a written Return Goods Authorization form (RGA) must be secured. The RGA must be used within 30 days of issuance and returned products must be properly cartoned and protected to avoid additional damage. Damages other than noted on the original RGA as well as missing parts may be adjusted in the credit and will be so noted.

Returns due to buyer's order errors will be considered based on condition, finish and product. Those items deemed returnable will be subject to a minimum 25% return/restock fee and must be returned pre-paid freight. Freight collect items will be refused.

Warranty

Jofco's warranty covers repair or replacement of any part or parts found to be defective, subject to normal wear and tear and proper care. Damages resulting from misuse, abuse, negligent use or modification will not qualify for warranty replacement. File drawers are manufactured for hanging files only; bottom loading will void warranty. The warranty applies to products manufactured by Jofco after March 1, 2006 and supercedes previously expressed warranties.

Jofco tables are warranted to the original purchaser to be free from defects in workmanship under normal, single shift use for a period of ten (10) years from date of initial shipment. All warranty claims must be made in writing.

Natural variations in grain, color or texture are inherent in wood and leather. Variations will be more noticeable when lighter finishes are specified. Differences may be detected between finishes applied to solid wood versus wood veneer. Cherry and maple veneer are photosensitive which may result in a deepening of color. None of these natural characteristics should be considered defects under this warranty.

Care and Maintenance

Catalyzed Lacquer Finishes

Dust furniture with the grain using a damp cloth. Clean surfaces with a vegetable oil based cleaner such as Murphy's Oil Soap. Never allow water or cleaner to remain on surface. When necessary, polish lightly with paste wax to restore original lustre and protect the wood surface. Always wipe with the direction of the grain.

Plastic Laminate Tops

Clean with damp cloth and regular household cleaner. Wipe dry immediately to prevent streaking.

Glass Surfaces

Clean with clean cloth, water and natural soap. Never use abrasive products like metallic sponges.

General Care Instructions

When selecting placement of furniture, avoid areas of direct sunlight which will cause the finish to fade or discolor over a period of time.

Scratches, dents, etc., may be repaired using color matching blending sticks or touch-up pens. To retain the furniture's value and original lustre, Jofco recommends a professional touch-up service.

Never use abrasive cleaners and blot rather than wipe spills.

Plastic materials may chemically plasticize with the top surface. Avoid setting plastic binders and items with plastic pads or rubber on your top surface.

Ordering Information

Jofco makes every effort to publish accurate and complete price lists. Please review the following section to ensure you can find all the information needed to fully specify our products.

A Description/Notes gives a description of the model numbers in that grouping.

B Model is an identification of the product. Look carefully at the model number. New model numbers have been implemented for the conferencing price list.

C Dimensions given in this price list are nominal and rounded to the nearest 1/8.

D Pricing is net pricing. Under Specify Options you may find some additional upcharges.

E Illustrations are based on information available at the time of printing and are subject to change without notice.

F Standard Features tells you what features are standard on the product.

G Specify Options gives you a step-by-step guide for building a complete specification. Options with an * are mandatory to make the order complete.

Modification Pricing is available on select product. See Specification Pages for modification pricing.





Ordering Information

Authorized Jofco dealers may order by email, fax or mail. Jofco Order Worksheet is in the back of price list.

Jofco-GSA Sales
P.O. Box 71
Jasper, IN 47547-0071
Fax: 812-634-2392
Email: gsa@jofco.com

Orders in the form of an email attachment should be sent to the attention of your Jofco Sales Coordinator. Phone orders must be confirmed in writing.

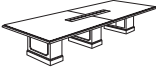
Example:
CC8JRP2-60216.Walnut.Amaretto

Jofco		Conferencing								
WELLINGTON	A DESCRIPTION/NOTES	B MODEL	C W D H			D WOM WNM WLM WSM				
	Rectangular Table	WE8JRR4-60144	144	60	29	10,821	10,908	11,239	11,239	
	F Standard Features top shaped all sides solid hardwood rims veneer is reverse slip-matched top is two sections 3/4" h apron base: (3) GP8NRT1-1230, 30" x 12" hardwood solids and veneers flat cut, book-matched vertical veneers adjustable glides seats 10 to 12	G Specify Options 1. wellington, westminster, windsor or without molding* 2. walnut or cherry veneer* 3. finish* 4. limited laminate selection, call for availability								
	Rectangular Table with Power	WE8JRR4-60144	144	60	29	16,396	16,516	16,816	16,816	
	Standard Features top shaped all sides solid hardwood rims veneer is reverse slip-matched top is two sections 3/4" h apron 30" w GP9ACT1-0930 console includes 8 power receptacles and 6 telecom plates console is brushed aluminum with retractable doors base: (2) GP8NRTK-1230, 30" x 12" open wire access, top of panel access door, 12" x 11" x 6" from floor (1) GP8NRTL-1230, 30" x 12" open wire access, top of both sides flat cut, book-matched vertical veneers adjustable glides seats 10 to 12	Specify Options 1. wellington, westminster, windsor or without molding* 2. walnut or cherry veneer* 3. finish* 4. limited laminate selection, call for availability								
	Rectangular Table	WE8JRP4-48144	144	48	29	9,195	9,362	9,739	9,739	
	Standard Features top shaped all sides solid hardwood rims veneer is reverse slip-matched top is two sections 3/4" h apron panels are 2 1/4" thick base: WE8NPT1-31114, 113 3/4 x 31 1/4 flat cut, book-matched vertical veneers horizontal rail is 4 1/4" h adjustable glides seats 10	Specify Options 1. wellington, westminster, windsor or without molding* 2. walnut or cherry veneer* 3. finish* 4. laminate top, no upcharge								
	Rectangular Table	WE8JRP4-48120	120	48	29	7,518	7,574	7,796	7,796	
	Standard Features top shaped all sides solid hardwood rims veneer is reverse slip-matched top is two sections 3/4" h apron panels are 2 1/4" thick base: WE8NPT1-31190, 89" x 31 1/4 flat cut, book-matched vertical veneers horizontal rail is 4 1/4" h adjustable glides seats 8	Specify Options 1. wellington, westminster, windsor or without molding* 2. walnut or cherry veneer* 3. finish* 4. laminate top, no upcharge								
How To Order:		Specify model number and options listed with each product section. Options marked with an asterisk are required. Failure to do so will delay order processing. Options without an asterisk will be made standard if not otherwise specified. EX: WE8JRR4-60144.Wellington Molding.Walnut.Tuscany.								

Updated price lists can be found by visiting www.jofco.com.

Finish Information

Finishes Available

Casegoods finishes are formulated to match seating and occasional table finishes as closely as possible. Finishes applied to solid wood reflect differently than finishes applied to veneers so slight variations in color may occur.

On Maple Wood Species - Available in CaseWorks by Jofco®, Reflections, and Collective®.

Linen
Butterscotch
Cinnamon
Ebony

On Walnut Wood Species - Available in Wellington, Walden, Reflections, and Collective®.

Mocha
Paprika
Toffee
Tuscany
Sienna
Amaretto
Espresso

On Cherry Wood Species - Available in CaseWorks by Jofco®, Reflections, and Wellington.

Caramel
Gingersnap
Merlot
Bordeaux
Java

On Makore (Cherry) Wood Species - Available in Collective®.

Caramel
Gingersnap
Merlot
Bordeaux
Java

On Anegre* Wood Species - Available in Collective®.

Champagne
Topaz

*Requires an upcharge. See M2 column of the price list.

Requests to have a series produced in a non-standard wood species should be given in writing to Jofco customer support. A minimum 10% upcharge will apply and lead times may be extended.

Paint Colors - Available in Collective®.

Autumn
Cool White
Spring
Storm
Summer
Warm White
Wheat
Winter

Certified Wood

Jofco is a Forest Stewardship Council (FSC) certified manufacturing facility. All wood products are available with optional FSC-certified core and veneer to meet the LEED requirement for certified wood. FSC-certified materials are available upon request only. Contact a Jofco Sales Coordinator for more information.

Finish and Color Matching

Veneers and solids are matched as closely as possible for acceptable blend and color match. Natural wood in all forms is uniquely varied, and these characteristics are acceptable within our strict limits and reflect the natural beauty of wood.

Special Finishes or Colors

Requests for finish color matching **must** include a sample of the requested color. Jofco will match the sample and send it to the dealer along with an acceptance form. Additional pricing will also be included. The order will not be entered and lead time will not begin until a signed copy of the acceptance form is received. It typically takes two weeks from color match to order entry. After receipt of acceptance, the order cannot be cancelled or returned.

Jofco does not bleach or distress finishes.

Collective® Conferencing and Meeting

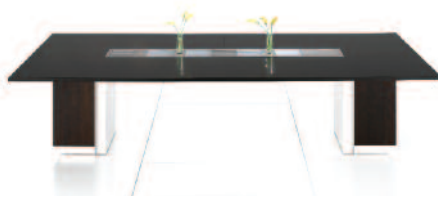

Conference Tables	5-52
Meeting Tables	53
Conference Table Tops	54-57
Conference Table Bases	57-62
Accessories	62-64

Overview

Collective®

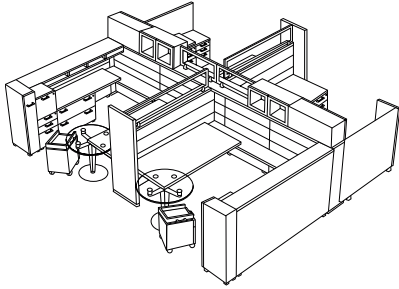

Collective@Space is an upscale approach to the open landscape creating working spaces that are inviting and flexible for users. Elevated by aluminum feet, the central element is the spine wall from which extend an array of integrated components.

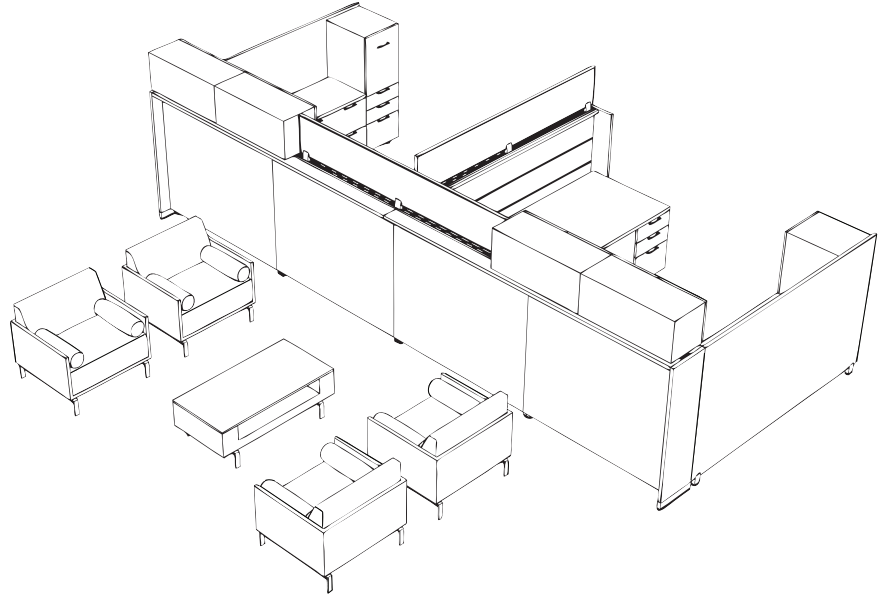

Collective@Space and Lounge

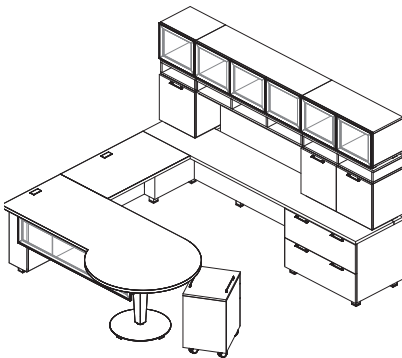

Collective@Office addresses the needs of the private office with a variety of footprints, desk shapes and a multitude of functional options. A user-oriented approach to the design inspired the use of off-modular work tools, tool drawers and seamless technology integration

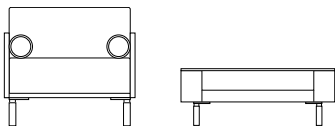

Collective@Lounge includes a group of Lounge Seating and Occasional Tables which complement the open plan and private office casegoods aesthetic and finishes. Both seating and tables are elevated on a satin chrome leg structure.

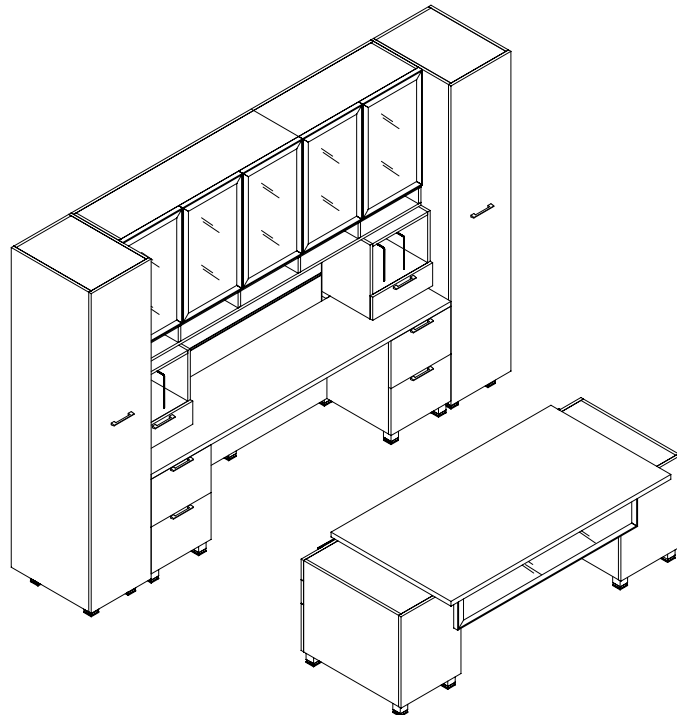

Collective@Office

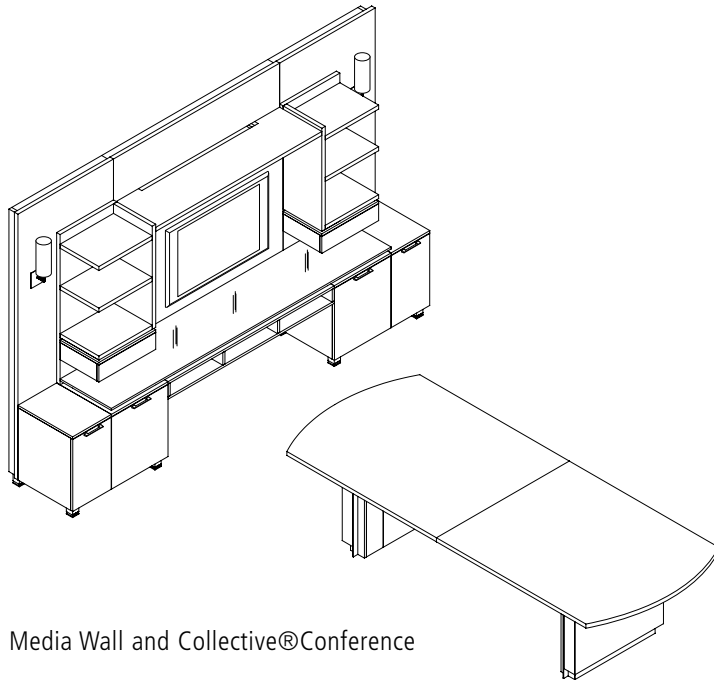

Media Wall and Collective@Conference

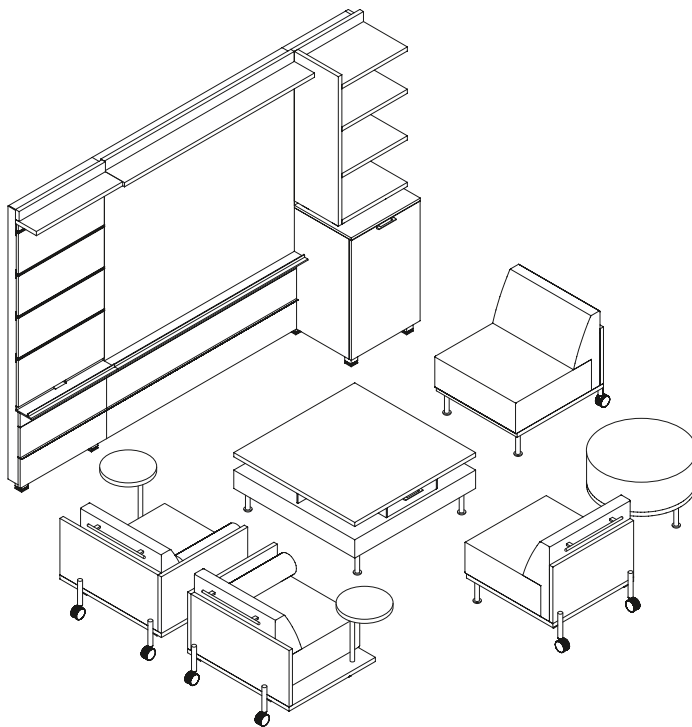

Interactive Wall and Collective@Motion

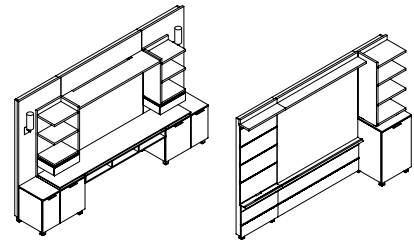

Media Wall

Interactive Wall

Collective@Presentation addresses today's information and presentation environments by providing technology integration and collaborative solutions for reception, private office, open plan, conference or casual meeting spaces. Comprised of center and ender components the modular system is easy to configure and specify.

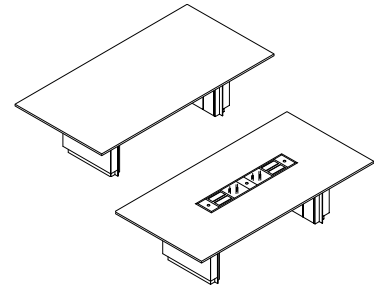

Collective@Conference lends itself to modern meeting environments by providing a continuous center console with modular functional and aesthetic options. Tables can be specified to address technology and meeting needs and create an image statement.

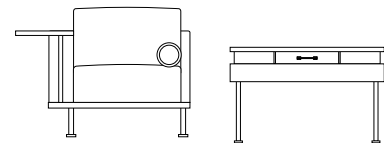

Collective@Motion includes mobile lounge seating and occasional tables with power and data option. Available in single or dual textile combinations, the easily rearranged series creates an infinite array of configurations for reception, meeting, study, library and cafe areas.

Collective® Conference Bases

Base Types

Collective® Conference offers four base styles: open cable, closed cable, panel and rectangular.

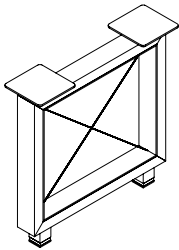

Open Cable Base

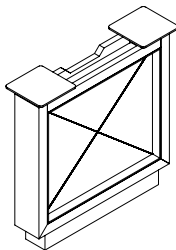

Closed Cable Base

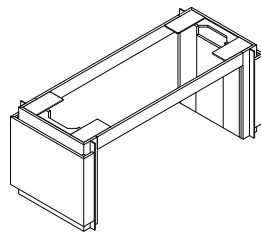

Panel Base

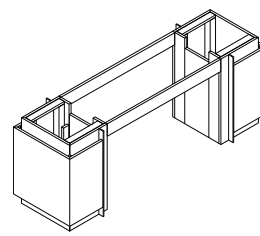

Rectangular Base

Open Cable Bases

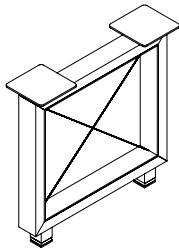

The open cable base features a $\frac{13}{16}$ " X-shaped stainless steel cable accent. Open cable bases provide no wire management compartment. The outer frame is wood with a metal inner frame in silver powder coat. Telescopic feet provide $1\frac{1}{2}$ " leveling adjustment.

Closed Cable Bases

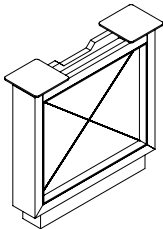

outside base
side 1

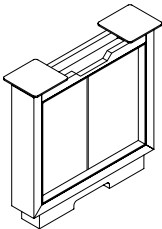

side 2

Closed cable bases include a hinged door compartment and plinth base for wire management.

The outside closed cable base features a visible $\frac{13}{16}$ " X-shaped stainless steel cable accent on the side opposite the hinge door. Wires pass through an opening above hinged doors. The base is wood with a metal silver powder coated inner frame.

The middle closed cable base features a wood panel on the side opposite the side hinged door. Wires pass through opening at the top of both sides.

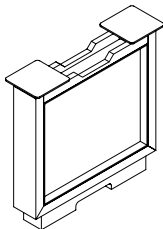

middle base
side 1

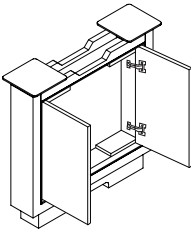

side 2

Collective® Conference Bases

Panel Bases

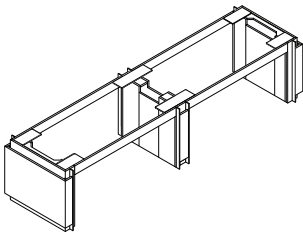

The panel base features slim wood pedestals surrounded by a wood accent. Each pedestal has a hinged door for wire management access and features a silver powder coat fin detail.

Rectangular Bases

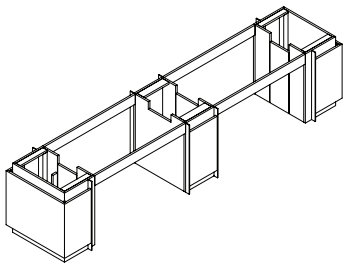

The rectangular base features wide wood pedestals surrounded by a wood accent. Each pedestal has a hinged door for wire management access, an ample storage compartment, and features a silver powder coat fin detail.

Cable Base Materials

Open Cable Base

The open cable base is available in veneer only.

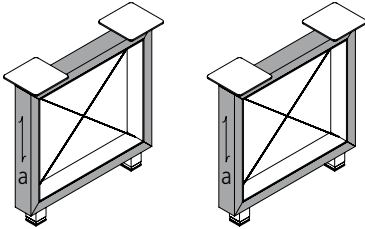

Open Cable Base
a. outer frame - veneer only

Closed Cable Base

There are two material options for the closed cable base. The outer frame and plinth are always veneer. The inner panel/door can be specified in the matching veneer or in a contrasting paint.

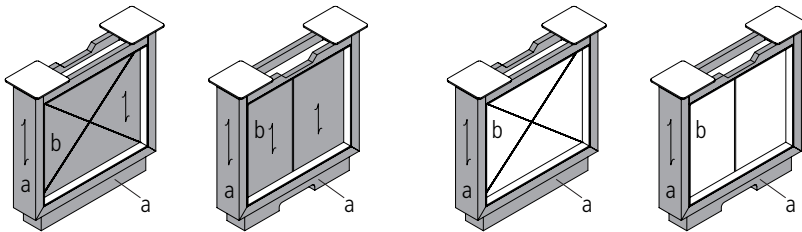

a. outer frame/plinth - veneer
b. inner panel/door - veneer

a. outer frame/plinth - veneer
b. inner panel/door - paint

Base Material Options

This form must accompany order when specifying open or closed cable bases for Collective®Conference.

Cable Base Material Ordering

Outer frame and plinth (a) are available in veneer only. Inner panel/door (b) can be veneer or paint and are always same material as the outer frame. Veneer choices are maple, walnut, and makore. Anegre wood species requires an upcharge; See M2 column on pricing pages. Paint colors are spring, storm, summer, wheat, autumn, warm white, winter or cool white.

Areas shown in white are finished in silver powder coat.

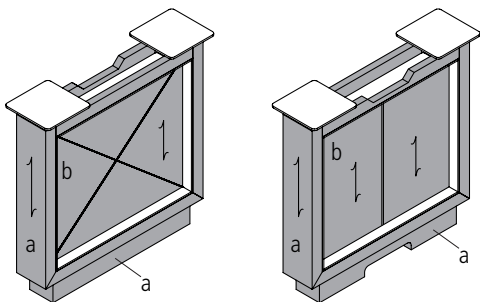

Base Model Number: _____

Wood Species: _____

Option 1: All Veneer

Veneer Finish: _____

Option 2: Veneer/Paint Combination

Outer Frame/Plinth (a)

Veneer Finish: _____

Inner Panel/Access Door (b)

Paint Color: _____

Panel and Rectangle Base Materials

Panel and Rectangle Base Material Options

There are three material options for the panel and rectangle bases.

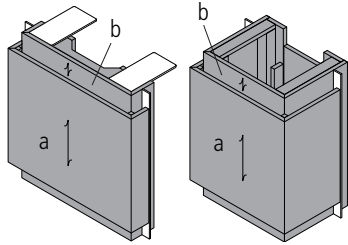

- a. accent panel - veneer
- b. base pedestal - veneer
- c. apron (shown below) - veneer

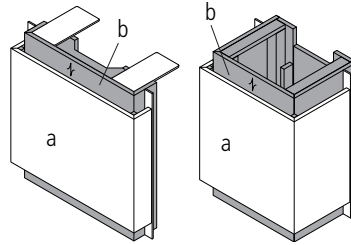

- a. accent panel - paint
- b. base pedestal - veneer
- c. apron (shown below) - veneer

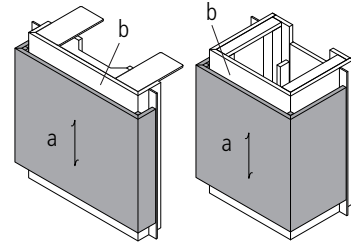

- a. accent panel - veneer
- b. base pedestal - paint
- c. apron (shown below) - paint

Base Material Options

This form must accompany order when specifying panel or rectangular bases for Collective®Conference.

Panel and Rectangle Base Material Ordering

Accent (a) and base pedestal (b) are available in veneer or paint. The apron (c) is always the same material as the base pedestal. Veneer choices are maple, walnut, and makore. Anegre wood species requires a slight upcharge; See M2 column on pricing pages. Paint colors are spring, storm, summer, wheat, autumn, warm white, winter or cool white.

Fin detail (d) is finished in silver powder coat.

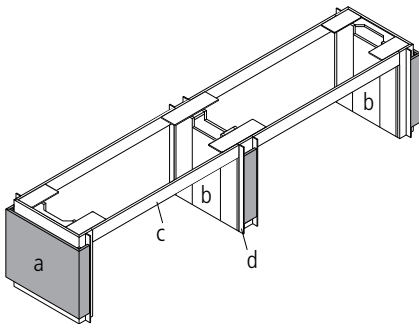

Panel Base

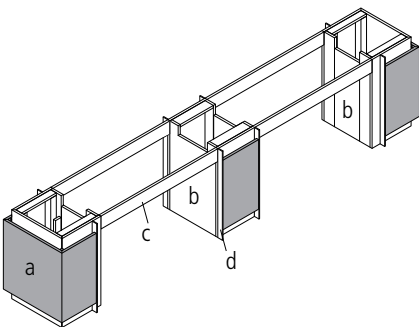

Rectangle Base

Base Model Number: _____

Wood Species: _____

Option 1: All Veneer

Veneer Finish: _____

Option 2: Veneer/Paint Combination

Accent (a)

Paint Color: _____

Base (b) & Apron (c)

Veneer Finish: _____

Option 3: Veneer/Paint Combination

Accent (a)

Veneer Finish: _____

Base (b) & Apron (c)

Paint Color: _____

Collective® Conference Center Console

Center Console Overview

The continuous center console supports a variety of functional and aesthetic options. A Collective® Conference table with center console includes: the center spine assembly which houses 4", 8", 12" and 16" modules, ordered separately; the understructure of the console; and wire management tray as illustrated below.

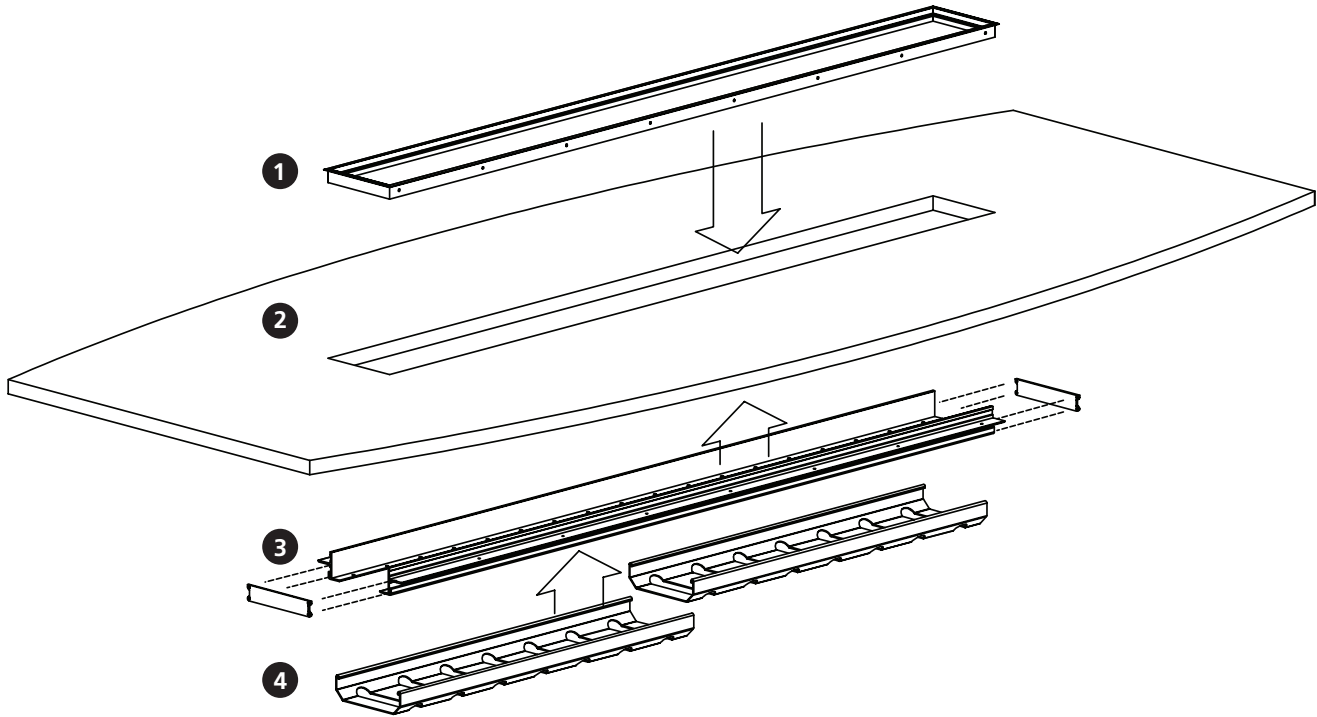

1 Center Spine Bezel Assembly

The center spine bezel assembly accepts the 4", 8", 12" and 16" modules shown on pages 10, 62-64 of the pricing section of this price list.

3 Center Spine Structural Extrusion Assembly

When a table with center console is specified, the center spine structural extrusion assembly is attached to the underside of the table top.

2 Table Top

Tops are available in several shapes including rectangular, racetrack, ellipse, arc end, boat and view. They come with or without center console.

4 Wire Management Tray

When using power/data and lamp modules, the wire management tray channels the cords to the panel or rectangular bases.

Collective® Conference Center Console Components

Collective® Conference is available with a center console for storage, power/data and accessories. The center console is offered in lengths of: 48", 72", 96", 120", 144" & 160". The accessories are offered in 4" increments. When designing your center console the accessories selected must equal the length of your console. **The center console is factory installed. You must specify the order in which you want the accessories to appear using the chart on the bottom of the page.**

Example of 72" Console:

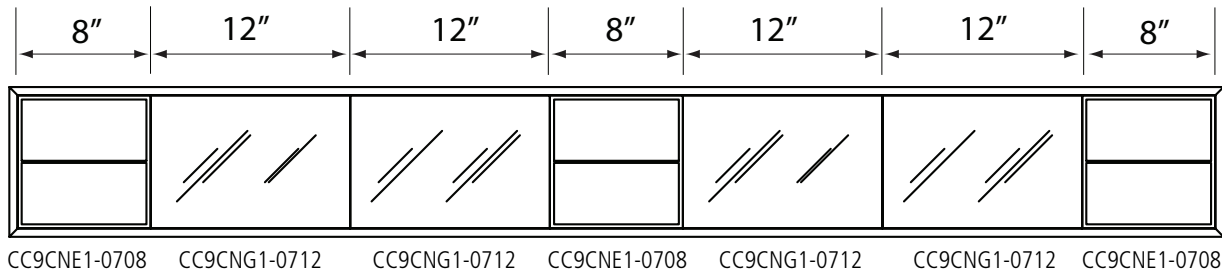

Center Console Accessories

Storage



Glass Panels

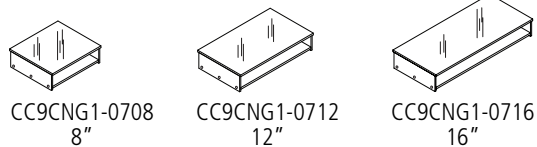

Lamp

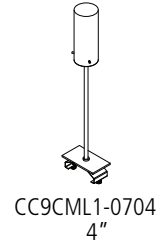

Vase



Accessory Shelf

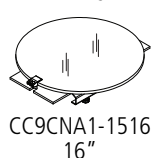

Coaster

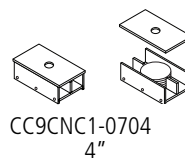

Power Data Module



Table vs. Console Length Chart

Use the following chart to determine the console length.

Table Length	Console Length
216"	160"
192"	144"
168"	120"
144"	96"
120"	72"
96"	48"

How to Order

You must specify the order in which you want the accessories to appear.

Console Length _____

Item	Length	Item	Length
1. _____	_____	11. _____	_____
2. _____	_____	12. _____	_____
3. _____	_____	13. _____	_____
4. _____	_____	14. _____	_____
5. _____	_____	15. _____	_____
6. _____	_____	16. _____	_____
7. _____	_____	17. _____	_____
8. _____	_____	18. _____	_____
9. _____	_____	19. _____	_____
10. _____	_____	20. _____	_____

*Total length of accessory items must equal total length of console. _____

Collective® Conference Specifications

Materials

Exterior surfaces of cases are walnut, maple, makore, and anegre. Anegre requires upcharge; see M2 pricing column. Solid maple lumber is used with maple veneers. Solid walnut lumber is used with walnut veneers. Solid cherry lumber is used with makore and anegre veneers. Painted Surfaces are filled 1/16" thick sanded substrate.

Maple, walnut, and makore face veneers are flat cut to ensure consistency of grain pattern. Top veneers are reverse slip-matched. Aluminum parts are either extruded aluminum with anodized finish machined to specification or fabricated steel painted with a powder coat finish.

Finishes Available

On Walnut Wood Species:

Mocha
Paprika
Toffee
Tuscany
Amaretto
Sienna
Espresso

On Maple Wood Species:

Linen
Butterscotch
Cinnamon
Ebony

On Makore Wood Species:

Caramel
Gingersnap
Merlot
Bordeaux
Java

On Anegre* Wood Species:

Champagne
Topaz

* Anegre requires a upcharge. See M2 column on pricing pages.

Paint Colors

Autumn
Cool White
Spring
Storm
Summer
Warm White
Wheat
Winter

Laminate Top Option

Black Granite L1
Sandstone L2
Light Stone L3
Greystone L4
Call Jofco to verify matching finish laminate.

Work Surfaces and Components

Collective®Conference has a wide variety of shapes, sizes and supports.

Tops

Tops are 3mm self-rimmed. Wood tops are 1 1/4" thick with a 29" standard height. Glass tops are 5/8" thick with eased edges. They are screen-printed for a frosted appearance and feature a fingerprint resistant coating on the underside.

Aluminum Edge Trim

The anodized aluminum trim is 1/16" thick and is available as an option on rectangular tables only.

Center Console

Center console is a clear anodized aluminum with a extruded mitre frame.

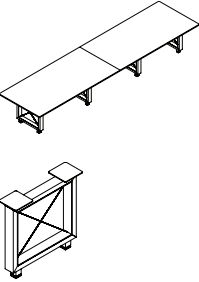
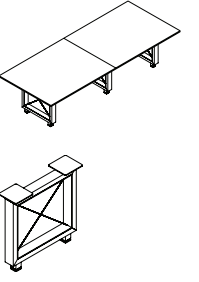
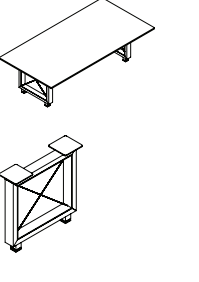
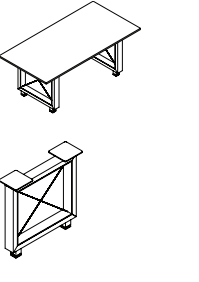
OPEN CABLE BASES	DESCRIPTION/NOTES	MODEL	W	D	H	M1	M2
	<p>Rectangular Table with Open Cable Base</p> <p>Standard Features veneer top is reverse slip-matched veneer runs short grain top is 1 1/4" thick top is in two sections base: (4) CC8NCO1-0427 telescopic feet are anodized aluminum telescopic feet provide 1 1/2" leveling adjustment seats 14 to 16</p> <p>Specify Options 1. walnut, makore, maple veneer, see column M1; anegre veneer, see column M2* 2. finish* 3. laminate top, no upcharge 4. aluminum edge, add \$3825</p>	CC8JRX1-48192	192	48	29	18,163	20,888
	<p>Rectangular Table with Open Cable Base</p> <p>Standard Features veneer top is reverse slip-matched veneer runs short grain top is in two sections top is 1 1/4" thick base: (3) CC8NCO1-0427 telescopic feet are anodized aluminum telescopic feet provide 1 1/2" leveling adjustment 168" seats 12 to 14 144" seats 8 to 10 120" seats 6 to 8</p> <p>Specify Options 1. walnut, makore, maple veneer, see column M1; anegre veneer, see column M2* 2. finish* 3. laminate top, no upcharge 4. aluminum edge, 168" top, add \$3443, 144" top, add \$3060, 120" top add \$2678</p>	<p>CC8JRX1-48168</p> <p>CC8JRX1-48144</p> <p>CC8JRX1-48120</p>	168	48	29	14,273	16,414
	<p>Rectangular Table with Open Cable Base</p> <p>Standard Features veneer top is reverse slip-matched veneer runs long grain top is 1 1/4" thick base: (2) CC8NCO1-0427 telescopic feet are anodized aluminum telescopic feet provide 1 1/2" leveling adjustment seats 6 to 8</p> <p>Specify Options 1. walnut, makore, maple veneer, see column M1; anegre veneer, see column M2* 2. finish* 3. laminate top, no upcharge 4. aluminum edge, add \$2295</p>	CC8JRX1-4896	96	48	29	8,451	9,718
	<p>Rectangular Table with Open Cable Base</p> <p>Standard Features veneer top is reverse slip-matched veneer runs long grain top is 1 1/4" thick base: (2) CC8NCO1-0423 telescopic feet are anodized aluminum telescopic feet provide 1 1/2" leveling adjustment seats 4 to 6</p> <p>Specify Options 1. walnut, makore, maple veneer, see column M1; anegre veneer, see column M2* 2. finish* 3. laminate top, no upcharge 4. aluminum edge, 84" top add \$2008, 72" top add \$1722</p>	<p>CC8JRX1-4284</p> <p>CC8JRX1-3672</p>	84	42	29	6,874	7,905
			72	36	29	6,355	7,308

How To Order:

Specify model number and options listed with each product section. **Options marked with an asterisk are required.** Failure to do so will delay order processing. Options without an asterisk will be made standard if not otherwise specified.

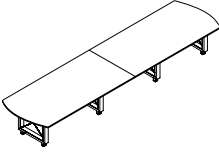
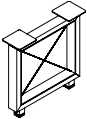
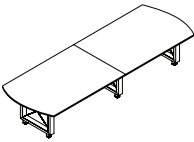
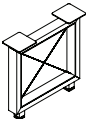
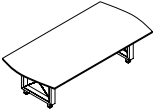
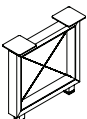
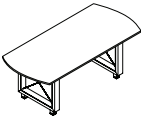
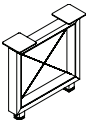
OPEN CABLE BASES	DESCRIPTION/NOTES	MODEL	W	D	H	M1	M2
 	Arc End Table with Open Cable Base	CC8JAX1-48192	192	48	29	18,545	21,326
	<p>Standard Features veneer top is reverse slip-matched veneer runs short grain top is 1¼" thick top is in two sections base: (4) CC8NCO1-0427 telescopic feet are anodized aluminum telescopic feet provide 1½" leveling adjustment seats 14 to 16</p> <p>Specify Options 1. walnut, makore, maple veneer, see column M1; anegre veneer, see column M2* 2. finish* 3. laminate top, no upcharge</p>						
 	Arc End Table with Open Cable Base	CC8JAX1-48168 CC8JAX1-48144 CC8JAX1-48120	168 144 120	48	29	14,600 13,474 12,558	16,790 15,495 14,442
	<p>Standard Features veneer top is reverse slip-matched veneer runs short grain top is 1¼" thick top is in two sections base: (3) CC8NCO1-0427 telescopic feet are anodized aluminum telescopic feet provide 1½" leveling adjustment 168" seats 12 to 14 144" seats 8 to 10 120" seats 6 to 8</p> <p>Specify Options 1. walnut, makore, maple veneer, see column M1; anegre veneer, see column M2* 2. finish* 3. laminate top, no upcharge</p>						
 	Arc End Table with Open Cable Base	CC8JAX1-4896	96	48	29	8,612	9,904
	<p>Standard Features veneer top is reverse slip-matched veneer runs long grain top is 1¼" thick base: (2) CC8NCO1-0427 telescopic feet are anodized aluminum telescopic feet provide 1½" leveling adjustment seats 6 to 8</p> <p>Specify Options 1. walnut, makore, maple veneer, see column M1; anegre veneer, see column M2* 2. finish* 3. laminate top, no upcharge</p>						
 	Arc End Table with Open Cable Base	CC8JAX1-4284 CC8JAX1-3672	84 72	42 36	29	6,991 6,440	8,040 7,406
	<p>Standard Features veneer top is reverse slip-matched veneer runs long grain top is 1¼" thick base: (2) CC8NCO1-0423 telescopic feet are anodized aluminum telescopic feet provide 1½" leveling adjustment seats 4 to 6</p> <p>Specify Options 1. walnut, makore, maple veneer, see column M1; anegre veneer, see column M2* 2. finish* 3. laminate top, no upcharge</p>						

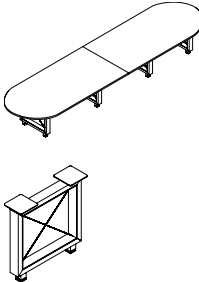
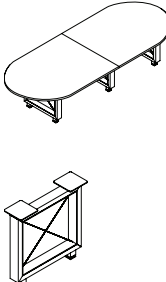
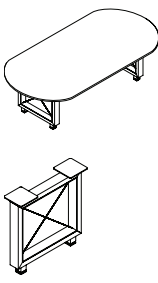
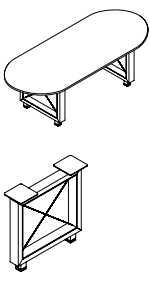
OPEN CABLE BASES	DESCRIPTION/NOTES	MODEL	W	D	H	M1	M2
	<p>Racetrack Table with Open Cable Base</p> <p>Standard Features veneer top is reverse slip-matched veneer runs short grain top is 1¼" thick top is in two sections base: (4) CC8NCO1-0427 telescopic feet are anodized aluminum telescopic feet provide 1½" leveling adjustment seats 14 to 16</p>	CC8JOX1-48192	192	48	29	18,672	21,472
	<p>Racetrack Table with Open Cable Base</p> <p>Standard Features veneer top is reverse slip-matched veneer runs short grain top is 1¼" thick top is in two sections base: (3) CC8NCO1-0427 telescopic feet are anodized aluminum telescopic feet provide 1½" leveling adjustment 168" seats 12 to 14 144" seats 8 to 10 120" seats 6 to 8</p>	<p>CC8JOX1-48168 CC8JOX1-48144 CC8JOX1-48120</p>	168 144 120	48 48 48	29 29 29	<p>14,709 13,565 12,633</p>	<p>16,915 15,600 14,528</p>
	<p>Racetrack Table with Open Cable Base</p> <p>Standard Features veneer top is reverse slip-matched veneer runs long grain top is 1¼" thick base: (2) CC8NCO1-0427 telescopic feet are anodized aluminum telescopic feet provide 1½" leveling adjustment seats 6 to 8</p>	CC8JOX1-4896	96	48	29	8,666	9,966
	<p>Racetrack Table with Open Cable Base</p> <p>Standard Features veneer top is reverse slip-matched veneer runs long grain top is 1¼" thick base: (2) CC8NCO1-0423 telescopic feet are anodized aluminum telescopic feet provide 1½" leveling adjustment seats 4 to 6</p>	<p>CC8JOX1-4284 CC8JOX1-3672</p>	84 72	42 36	29 29	<p>7,030 6,468</p>	<p>8,084 7,438</p>

How To Order:

Specify model number and options listed with each product section. **Options marked with an asterisk are required.** Failure to do so will delay order processing. Options without an asterisk will be made standard if not otherwise specified.

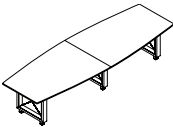
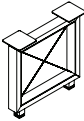
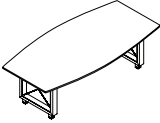
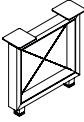
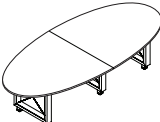
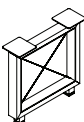
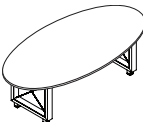
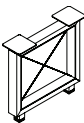
OPEN CABLE BASES	DESCRIPTION/NOTES	MODEL	W	D	H	M1	M2
 	Boat Shape Table with Open Cable Base Standard Features veneer top is reverse slip-matched veneer runs short grain top is 1¼" thick top is in two sections base: (3) CC8NCO1-0427 telescopic feet are anodized aluminum telescopic feet provide 1½" leveling adjustment CC8JBX1-48144: 144"w x 36/48"d CC8JBX1-48120: 120"w x 36/48"d 144" seats 8 to 10 120" seats 6 to 8	CC8JBX1-48144 CC8JBX1-48120	144 120	48 48	29 29	14,674 13,539	16,875 15,570
		Specify Options 1. walnut, makore, maple veneer, see column M1; anegre veneer, see column M2* 2. finish* 3. laminate top, no upcharge					
 	Boat Shape Table with Open Cable Base Standard Features veneer top is reverse slip-matched veneer runs long grain top is 1¼" thick base: (2) CC8NCO1-0427 telescopic feet are anodized aluminum telescopic feet provide 1½" leveling adjustment top size: 96"w x 34/48"d seats 6 to 8	CC8JBX1-4896	96	48	29	9,346	10,748
		Specify Options 1. walnut, makore, maple veneer, see column M1; anegre veneer, see column M2* 2. finish* 3. laminate top, no upcharge					
 	Ellipse Table with Open Cable Base Standard Features veneer top is reverse slip-matched veneer runs long grain top is 1¼" thick top is in two sections base: (3) CC8NCO1-0427 telescopic feet are anodized aluminum telescopic feet provide 1½" leveling adjustment seats 8 to 10	CC8JEX1-54120	120	54	29	14,000	16,100
		Specify Options 1. walnut, makore, maple veneer, see column M1; anegre veneer, see column M2* 2. finish* 3. laminate top, no upcharge					
 	Ellipse Table with Open Cable Base Standard Features veneer top is reverse slip-matched veneer runs long grain top is 1¼" thick base: (2) CC8NCO1-0423 telescopic feet are anodized aluminum telescopic feet provide 1½" leveling adjustment seats 6 to 8	CC8JEX1-4896	96	48	29	9,662	11,111
		Specify Options 1. walnut, makore, maple veneer, see column M1; anegre veneer, see column M2* 2. finish* 3. laminate top, no upcharge					